

B1900

Spectrum Aeromed is recognized as a world leader in creating customized and durable, highly functional air medical transport equipment that complies with aviation regulations. All engineering and design of our air ambulance life support systems comes from working hand-in-hand with air medical personnel worldwide.

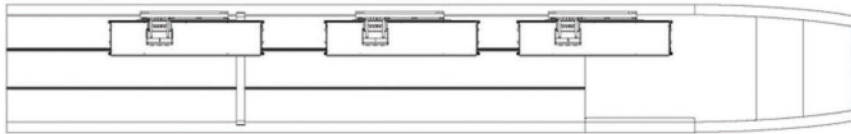

Triple 2800 Series System Install

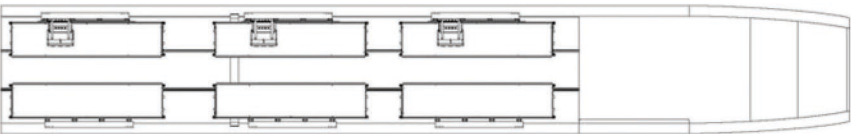

Six 2800 Series System Install

System Overview:

- Quick change capability can be installed or removed from aircraft in approx. 15 minutes and requires minimal modifications to the aircraft
- High quality, durable design and cost-effective installation
- Built aircraft-specific and customer-specific
- Allows for a variety of custom medical mounts and patient loading accessories

System Features & Options:

- Fully self-contained and lightweight
 - 3500 liters of oxygen, dual air compressors, vacuum pump and 1000 watt inverter
 - AC outlets, DC outlet and dual pneumatic outlets
- Custom stretcher specifically designed for patient comfort
- Multiple IV Mounts

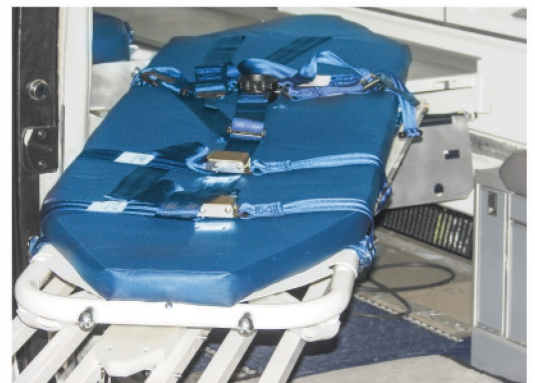

1815 23rd Avenue North • Fargo, ND 58102

+1 701.235.5478 • Toll Free: 1.800.753.4340 • Fax: +1 701.235.5486

Email: Aeromed@Spectrum-Aeromed.com • www.Spectrum-Aeromed.com